



فرست اوتوماشن

Switch Handle

Series CZ2000-1-BF7



Products Features

- CZ2000/1-BA7 Switch modules have 2P or 4P for options, can be used together with 11 different operation heads (pushbuttons, switches, key operated switches, E-stop pushbuttons).
- CZ2000/1-BB7 control switch module, available in 2P~12P control functions.
- CZ2000/1-BD7 Signal lamp module, LED light source, four voltage ratings, five colors in red, green, yellow, white, blue are available.
- CZ2000/1-BG7 Light-control switch module, can be applied to Ex d or Ex e enclosure.
- CZ2000/1-BP7 Flameproof potentiometer module, 100Ω~2MΩ, Max 0.1W.
- CZ2000/1-B□ switch handle, to operate the switch modules 63A, 100A, 250A, 400A, 630A from the front. or to operate the switch modules 100A, 250A from the side.
- CZ2000/1-BW7 observation window for instruments φ64mm, φ89mm.
- CZ2000/1-BI7 observation and operation window for instruments, window have four sizes.
- CZ2000/2A Flameproof cable bushing, thread size M16 to M80, conductor size 0.5mm²-120mm².
- CZ2000/2B Flameproof cable bushing, thread M50, conductor size 0.5mm²-120mm², to be used for the connection of two Ex d enclosures.
- CZ2000/3 Flameproof binding pillar, thread M42, wiring capacity 50mm²-240mm².
- International IECEx approval, European union ATEX certifications (U).
- Accessories: special spanner, label, safety latch.



فرست اوتوماشن

Switch Handle

Series CZ2000-1-BF7



Product Parameter

Product type:	Exd flameproof switch handle
Certification:	IECEX ATEX
Application range (zones):	2G/Gb/zone 1; 2Db/Db/zone 21
Min.ambient temperature:	-55°C
Max.ambient temperature:	+60°C
Min.service temperature:	-55°C
Max.service temperature:	+80°C
Degree of protection:	IP66
Flameproof thread:	M16×1.5, M25×1.5
Tightening torque:	8 N.





فرست اوتوماشن

Switch Handle

Series CZ2000-1-BF7



Illustration	Order No.
	CZ2000/1-BF7-CZ-184.3/L
	CZ2000/1-BF7-CZ-184.3/F
	Label: 4031/8
	CZ2000/1-BC7-CZ2-1342
	CZ2000/1-BC7-CZ2-145.3
	CZ2000/1-BE7-CZ2-2308.2
	CZ2000/1-BE8-CZ2-1342/CZ
	CZ2000/1-BE8-CZ2-145.3/CZ

Contact

info@first-automation.com.eg/ • 01101619222 – 01100200886 • <https://first-automation.com.eg/>



Switch Handle

Series CZ2000-1-BF7



Outline dimensions

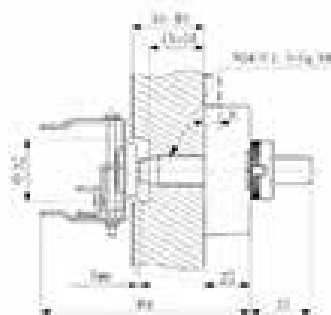
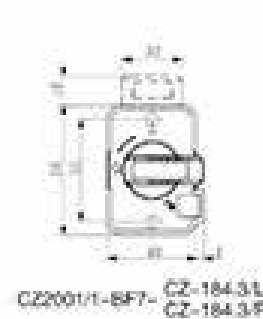

Mounting distance

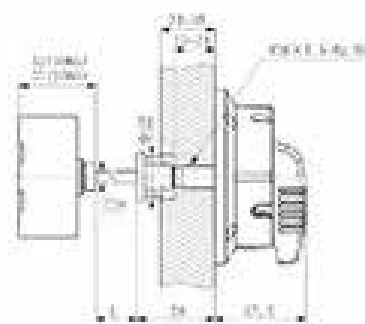
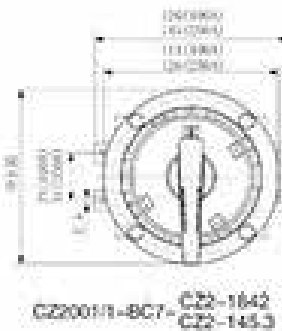
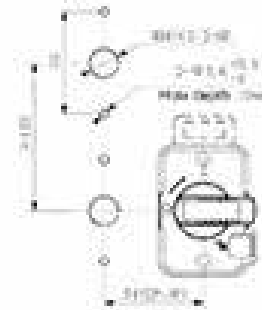

Hole dimension

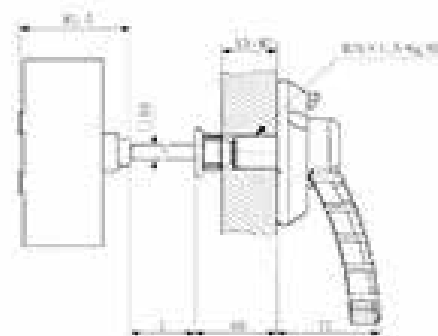
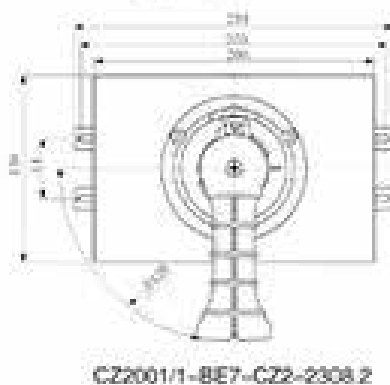

Hole dimension



Note: Square shaft length L=□8 x 200mm, L=□10 x 150mm Standard size



فرست اوتوماشن

Switch Handle

Series CZ2000-1-BF7



Outline dimensions

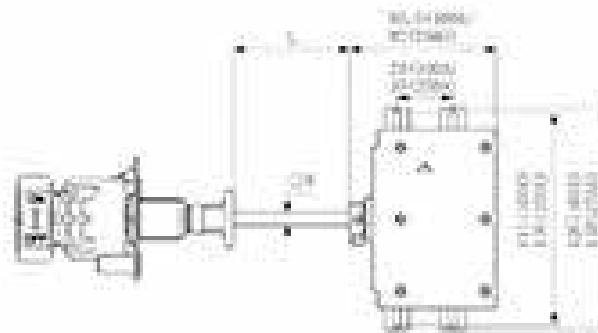
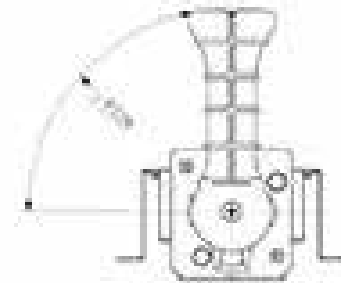
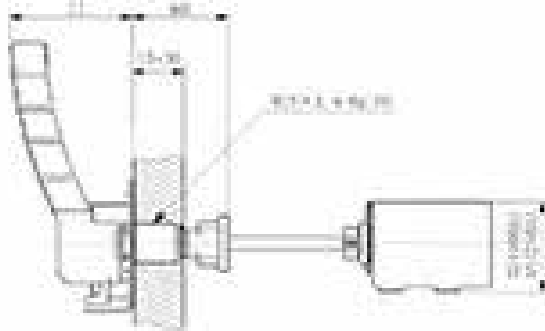

CZ2000/1-800- CZ-1342/CZ
CZ-145.3/CZ

Hole dimension

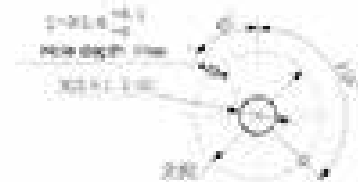

Outline dimensions

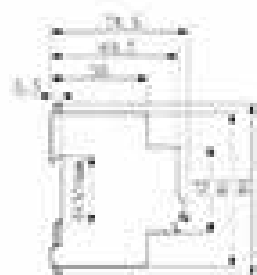
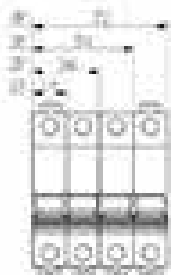

Miniature circuit breaker IC65

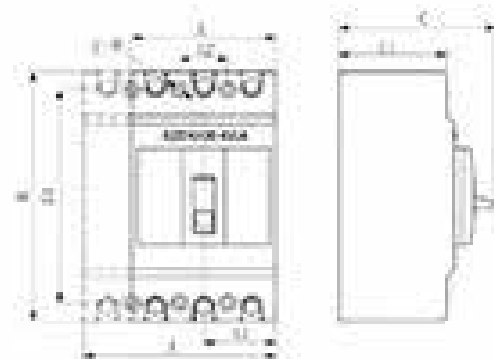

Molded case circuit breaker

Type	A	A1	A2	B	B1	C	C1	Φ
1ZD100E-100L/1P	75	27.5	25	110	111	41	35	4.5
1ZD100E-100L/1P	100	27.5	25	130	111	41	35	4.5
1ZD100E-250L/1P	104	32.5	35	164	126	50	35	4.5
1ZD100E-250L/1P	110	32.5	35	165	126	50	35	4.5
1ZD100E-630L/630A/1P	140	70	65	235	200	100	55	7
1ZD100E-630L/630A/1P	145	70	65	235	200	100	55	7



فرست اوتوماشن

Switch Handle

Series CZ2000-1-BF7



Accessories



Spanners

used to tighten plastic nuts M30×1.5

4006